

Item	Description
1	Back of House, Chiller 4m x 2.4m, Genny 4.6m x 1.5m Buffer Tank 1m x 1m, Pumps 1m x 0.8m, Fuel tank 1.5m x 3m.
2	Skate Exchange Marquee
3	Ice Rink
4	Box Office
5	Noise reducing wooden fence around back of house
6	Skate Entrance/Exit
7	Viewing Platform
8	Christmas Street Food Market
9	Trackway, Christmas Food Market
10	2400mm Wide Trackway.
11	White Plastic fencing
12	Christmas trees
13	Gen sets and Vehicles
14	Dodgems 24m x 16m
15	Food and Bar
16	Avalanche
17	Polar Express Train Ride 25m x 14m
18	Slide 20m x 10m
19	Snowball Games
20	Santas Slay
21	Games
22	Kiddies Rides
23	Carousel
24	Helter Skelter
25	Christmas Fair Trackway
26	Back of House Trackway

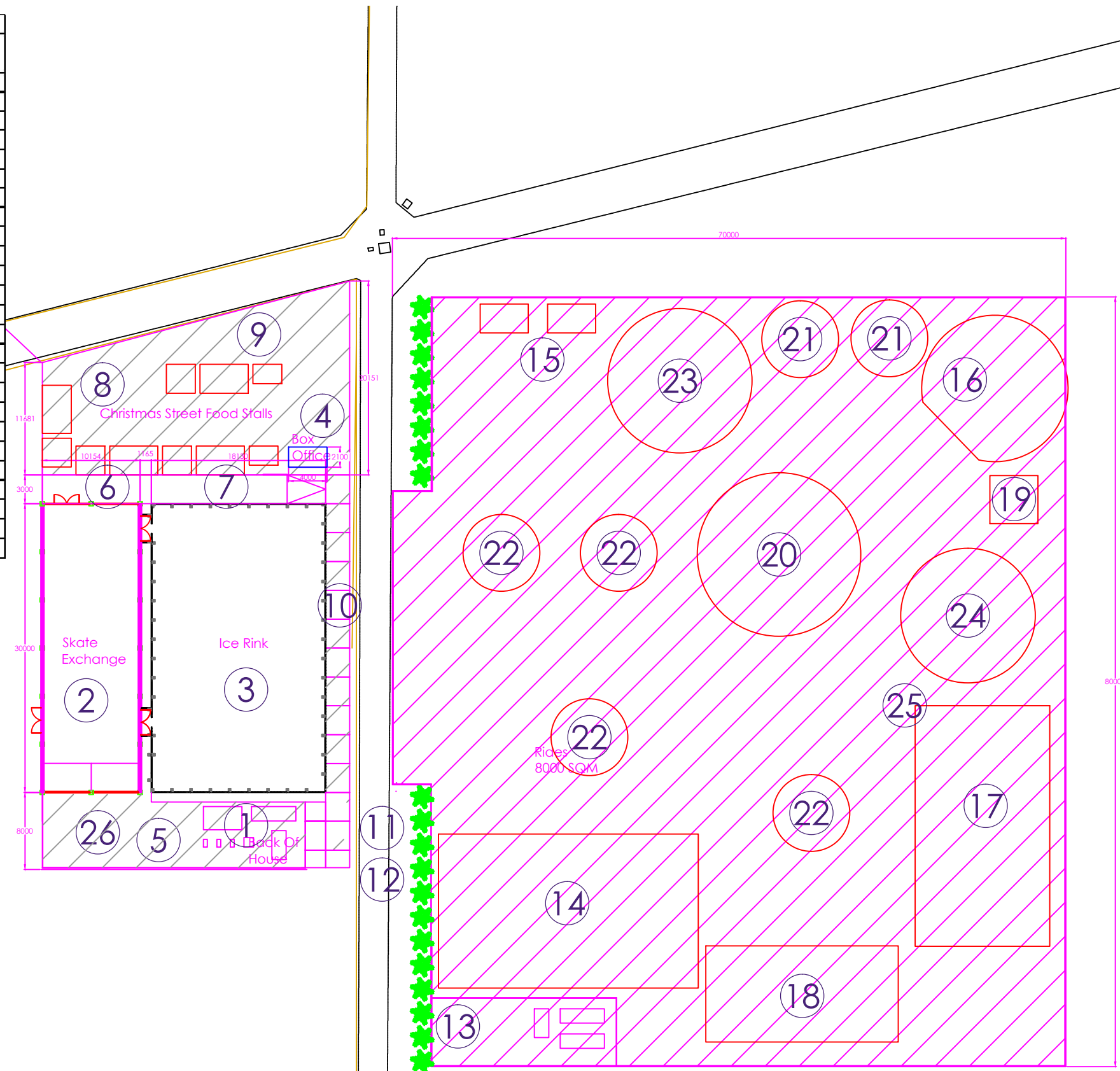

NOTES & REVISIONS:  
01.05.2014 - Rev B - Legend added - LSC

14.05.2014 - Rev C - Legend added - LSC

26.05.2014 - Rev D - Legend updated - LSC

30.05.2014 - Rev E - Layout change and Legend updated - LSC

03.06.2014 - Rev F - Layout change and Legend updated - LSC

13.06.2014 - Rev G - Layout change - LSC

18.06.2014 - Rev H - Dimension Added - LSC

19.06.2014 - Rev I - Dimension Added - LSC

11.08.2014 - Rev J - Updated Plan - LSC

13.08.2014 - Rev K - Updated Plan - LSC

CLIENT:  
Ice Box

PROJECT:  
Cambridge

TITLE:  
The North Pole  
@ Parkers Piece Cambridge  
Site Plan

DRAWING REF - REVISION:  
C2070/01/01 - K

DRAWN:  
LSC

DATE:  
01 April 2014

APPROVED:  
N/A

SCALE:  
1:500@A3

WORKS NO:  
N/A

