



Cambridge City Council Licensing Sub Committee

Date: Monday, 13 December 2021

Time: 10.30 am

Venue: Committee Room 1 & 2, The Guildhall, Market Square, Cambridge, CB2 3QJ

Contact: democratic.services@cambridge.gov.uk, tel:01223 457000

Agenda

- 1 Appointment of a Chair
- 2 Declarations of Interest
- 3 Meeting Procedure
- 4 Best One Express

(Pages 7 - 38)

Licensing Sub Committee Members: Bennett, Collis and McPherson, TBC

Information for the public

The public may record (e.g. film, audio, tweet, blog) meetings which are open to the public. For details go to:

www.cambridge.gov.uk/have-your-say-at-committee-meetings

For full information about committee meetings, committee reports, councillors and the democratic process:

- Website: <http://democracy.cambridge.gov.uk>
- Email: democratic.services@cambridge.gov.uk
- Phone: 01223 457000

Public health and well-being for meeting arrangements

Whilst the situation with COVID-19 is on-going, the Council will be following the latest Government guidance in organising and holding its meetings.

We ask you to maintain social distancing at all times and maintain your face covering unless you are exempt or when speaking at the meeting.

Hand sanitiser will be available on entry to the meeting.

Licensing Act 2003 - Licensing Sub-Committee: Hearings Procedure

Preliminary Matters

1. **The Chair** will commence the hearing by introducing him/herself, the other two members of the Sub-Committee and the officers present.
2. **The Chair** will ask the applicant(s)/the responsible authorities/the interested parties present, and their representatives (if applicable), to introduce themselves and identify their interest in the proceedings.

Failure of a party to attend the hearing

3. If a party has informed the licensing authority that he/she does not intend to attend or be represented at a hearing, the hearing may proceed in his/her absence.
4. If a party who has not so indicated fails to attend or be represented at a hearing, the Sub-Committee may –
 - (a) where it considers it to be necessary in the public interest, adjourn the hearing to a specified date, or
 - (b) hold the hearing in the party's absence.
5. Where the Sub-Committee holds the hearing in the absence of a party, the Sub-Committee will consider at the hearing the application, representations or notice made by that party.
6. **The Chair** will explain the procedure to be followed at the hearing and will confirm whether the Sub-Committee must reach its decision at the end of the hearing or within 5 working days of the hearing, depending on the application being heard.
7. **The Clerk to the Sub-Committee** will indicate whether any party has requested permission for any other person(s) (other than his/her representative) to appear at the hearing to assist the Sub-Committee in relation to the application, representations or notice of the party making the request. The Sub-Committee will decide whether to grant permission to allow any other person(s) to appear at the hearing on behalf of the party; such permission will not be unreasonably withheld.
8. **The Clerk to the Sub-Committee** will ask whether any party is seeking to introduce any document(s) or other information not previously disclosed to all the other parties to the hearing and the licensing authority. If all the other parties consent, the previously undisclosed document(s) or other information can be produced by a party in support of their application, representations or notice (as applicable).
9. The hearing will take the form of a discussion led by the Chair of the Sub-Committee. Cross-examination will not be permitted unless the Sub-Committee considers that cross-examination is required to

consider the representations, application or notice as the case may require.

10. The Sub-Committee will consider any requests to permit cross-examination on a case-by-case basis. When permission is given to one party, it will also normally be extended to all other parties.

11. The Sub-Committee will decide the equal maximum period of time that each party will have to present their case.

The Hearing

12. *The Licensing Officer will present the report to the Sub-Committee.*

13. Members may ask any relevant questions of the Licensing Officer.

14. *The applicant, or the party who has initiated the hearing, will present their case first.*

15. The party shall be entitled to:

(a) give further information in support of their application, representations or notice (as applicable) in response to a specific request by the licensing authority prior to the hearing;

(b) question any other party (if permission has been given by the Sub-Committee);

(c) address the Sub-Committee.

16. If the Police are a party to the hearing, they will present their case. The Police have the rights listed in paragraph 15 (a) – (c) above.

17. If any other “responsible authority” are a party to the hearing, they will present their case in turn after the Police and have the rights listed in paragraph 15 (a) – (c) above.

18. Any other interested parties will then present their case in turn and have the rights listed in paragraph 15 (a) – (c) above.

19. Members of the Sub-Committee may ask questions of the/each party or any other person permitted to appear at the hearing in support of the party.

20. **The Chair** will invite the applicant, or the party who has initiated the hearing, and any parties making representations, to briefly summarise their points if they wish.

21. **The Chair** will ask the applicant, or the party who has initiated the hearing, and all parties making representations, that they are satisfied that they have said all they wish to.

The Decision

22. In considering any representations or notice made by a party, the Sub-Committee may take into account documentary or other information produced by a party in support of their application, representations or notice (as applicable) either before the hearing or, with the consent of all the other parties, at the hearing.

23. In reaching its decision, the Sub-Committee will disregard any information given by a party, or any person who has been permitted to appear at the hearing, which is not relevant to –

- (a) the application, representations or notice (as applicable) or in the case of another person, the application, representations or notice of the party requesting their appearance, and
- (b) the promotion of the licensing objectives or, in relation to a hearing to consider a notice given by the Police, the crime prevention objective.

24. The Sub-Committee may consider its decision in private and may move into private session where it considers that the public interest in so doing outweighs the public interest in that part of the hearing taking place in public. If the Sub-Committee do move into private session then all the parties and their representatives, any other person permitted to appear at the hearing, officers, the public and the press will be asked to leave the room whilst the decision is made.

The Chair will tell those present at the meeting the decision taken by the Sub-Committee and the reasons for the decision.

This page is intentionally left blank

Agenda Item



CONSIDERATION OF AN APPLICATION FOR A PREMISES LICENCE TO BE GRANTED Best One Express, 4 Fitzroy Street, Cambridge, CB1 1EW

To: Licensing Sub-Committee:

Report by: Alexander Nix

Senior Technical Officer – Commercial & Licensing

Tel: 01223 457818 Email: alex.nix@cambridge.gov.uk

Wards affected: Market

INTRODUCTION

- 1.1 An application under Section 17 of the Licensing Act 2003 for a Premises Licence to be issued in respect of Best One Express, 4 Fitzroy St, Cambridge, CB1 1EW has been received from Dilip Bathula. It was served on Cambridge City Council (the Licensing Authority) on 19th October 2021.
- 1.2 The applicant is seeking a Premises Licence to supply alcohol off the premises only between 10:00 and 22:00 Monday to Sunday. The application is attached to the report as Appendix A with a proposed plan of the Premises attached at Appendix B.
- 1.3 In accordance with the regulations of the Act the application was advertised on the premises and in a local newspaper to invite representations from responsible authorities and other persons. The last date for submitting representations was 16th November 2021.
- 1.4 During the representation period the applicant agreed to the condition shown below put forward by Environmental Health under the Prevention of Public Nuisance Licensing objective.

“Collections from and or deliveries to the premises, shall only take place between the hours of 07:00 and 23:00. This shall include the placing of waste, including bottles, into waste receptacles outside the premises and the emptying of waste receptacles outside the premises and the emptying of waste receptacles by a waste contractor.”
- 1.5 The applicant also agreed to the addition of 16 conditions proposed by the Police under the Licensing Objectives (Listed below at Point 5). These are shown at Appendix C.
- 1.6 A representation was received on 15th November 2021 from one other person attached to the report at Appendix D.
- 1.7 No representations were received from any of the other Responsible Authorities.
- 1.8 The application needs to be determined.

2. RECOMMENDATION

- 2.1 Members must determine the application on its individual merits having reference to the statutory licensing objectives and Cambridge City Council's 'Statement of Licensing Policy'.

3. BACKGROUND

- 3.1 The premises are located within the city centre cumulative impact area. It is therefore subject to a special policy on cumulative impact. The special policy creates a rebuttable presumption that applications within cumulative impact areas for any new premises licence or variations that are likely to add to the existing cumulative impact will normally be refused if relevant representations are received about the cumulative impact on the licensing objectives.
- 3.2 This is unless, under Section 4.9 of the Cumulative Impact Assessment, the applicant can demonstrate why the operation of the premises involved will not add to the cumulative impact already being experienced.
- 3.3 In carrying out its licensing functions, the Licensing Authority must have regard to its Statement of Licensing Policy, the Cumulative Impact Assessment and additionally the statutory guidance issued under Section 182 of the Licensing Act 2003. The relevant sections from the Council's Statement of Licensing Policy are:
- Objectives - Section 2
 - Fundamental Principles - Section 4
 - Cumulative Impact - Section 5
 - Licensing Hours - Section 6
 - Licence Conditions - Section 8

4. CONSULTATIONS

- 4.1 The Licensing Act 2003 requires applications made under section 17 of the 'Act' to be served on the Responsible Authorities and they must also advertise on the premises and in a local newspaper circulating within the vicinity of the premises. During the consultation period, Responsible Authorities and Other Persons (any individual, body or business entitled to make representations to licensing authorities) may make a representation in respect of the application.

- 4.2 Statutory consultation has therefore taken place with Responsible Authorities and interested parties in accordance with the procedures set out in the Licensing Act 2003 and associated regulations made under the 'Act'.

5. OPTIONS

- 5.1 Whilst having reference to the information provided by the applicant and the information raised in the representation and also Cambridge City Council's Statement of Licensing Policy, the Sub-Committee's decision must be made with a view to promoting one or more of the four licensing objectives, namely:

- (a) the prevention of crime and disorder;
- (b) public safety;
- (c) the prevention of public nuisance; and
- (d) the protection of children from harm.

- 5.2 Members should take such steps that they consider are necessary for the promotion of the licensing objectives. The Sub-Committee may resolve:

- (a) to grant the licence subject to the mandatory conditions and those conditions offered by the applicant which may be modified to such extent as the authority considers necessary for the promotion of the licensing objectives;
- (b) to exclude from the scope of the licence any of the licensable activities to which the application relates;
- (c) to refuse to specify a person in the licence as the premises supervisor;
- (d) to reject the application.

- 5.3 Members must give reasons for their decision.

6. CONCLUSIONS

- 6.1 The Licensing Authority has a duty under the 'Act' to promote the Licensing Objectives. Each objective has equal importance. In carrying out its licensing functions, the Licensing Authority must also have regard to its Statement of Licensing Policy, and the Statutory Guidance under the Licensing Act 2003 and it is bound by the Human

Rights Act 1998. The Council must also fulfill its obligations under Section 17 of the Crime and Disorder Act 1998 to do all that it reasonably can to prevent crime and disorder in Cambridge.

7. IMPLICATIONS

a) Financial Implications

Cambridge City Council (the Licensing Authority) has a statutory duty to determine applications made under the Licensing Act 2003. The application fees associated with such applications are set by Central Government and are intended to cover the cost of administering the licensing regime.

There are no specific financial implications associated with this report.

(b) Staffing Implications

There are no staffing implications associated with this report.

(c) Equal Opportunities Implications

No Equality Impact Assessment has been conducted as the only consideration in reaching a decision is whether the granting of the application will undermine the statutory licensing objectives.

(d) Environmental Implications

Any environmental implications that need to be considered must specifically relate to the promotion of the statutory licensing objectives and will be contained in the representations made by the responsible authorities or interested parties.

(e) Community Safety

Cambridge Constabulary, Cambridgeshire Fire & Rescue Service, Cambridge City Council's Environmental Health Team, Cambridge City Council's Planning Service, Cambridgeshire County Council's Child Protection & Review Unit, Cambridgeshire County Council's Trading Standards Department and the Public Health Director were consulted as part of the application process and could have made representation if it was considered that the granting of the application would undermine one or more of the statutory licensing objectives.

Those making representations would have raised any relevant community safety implications.

8. BACKGROUND PAPERS: The following are the background papers that were used in the preparation of this report:

- [Licensing Act 2003](#)
- [The Licensing Act 2003 \(Premises licences and club premises certificates\) Regulations 2005](#)
- [Guidance issued under section 182 of the Licensing Act 2003](#)
- [The Council's Statement of Licensing Policy](#)
- [Statement of Licensing Policy: Cumulative Impact Assessment - Cambridge City Council](#)
- [Cambridge City Council – Guidance for Applicants](#)

Appendix List

Appendix A - Premises Licence Application Form Redacted

Appendix B - Premises Licence Plan

Appendix C – Conditions agreed with the Police

Appendix D – Redacted Representation

To inspect these documents either view the above hyperlinks or contact Alexander Nix on (01223) 457725.

The author and contact officer for queries on the report is Alexander Nix on (01223) 457725.

Date originated: 22nd November 2021

Late updated: 29th November 2021

Continued from previous page...

Address

* Building number or name	<input type="text"/>
* Street	<input type="text"/>
District	<input type="text"/>
* City or town	<input type="text"/>
County or administrative area	<input type="text"/>
* Postcode	<input type="text"/>
* Country	<input type="text" value="United Kingdom"/>

Agent Details

* First name	<input type="text" value="Stewart"/>
* Family name	<input type="text" value="Gibson"/>
* E-mail	<input type="text"/>
Main telephone number	<input type="text"/>
Other telephone number	<input type="text"/>

Include country code.

☐ Indicate here if you would prefer not to be contacted by telephone

Are you:

- ☐ An agent that is a business or organisation, including a sole trader
- ☒ A private individual acting as an agent

A sole trader is a business owned by one person without any special legal structure.

Your Address

Address official correspondence should be sent to.

* Building number or name	<input type="text"/>
* Street	<input type="text"/>
District	<input type="text"/>
* City or town	<input type="text"/>
County or administrative area	<input type="text"/>
* Postcode	<input type="text"/>
* Country	<input type="text" value="United Kingdom"/>

Continued from previous page...

I/we, as named in section 1, apply for a premises licence under section 17 of the Licensing Act 2003 for the premises described in section 2 below (the premises) and I/we are making this application to you as the relevant licensing authority in accordance with section 12 of the Licensing Act 2003.

Premises Address

Are you able to provide a postal address, OS map reference or description of the premises?

☒ Address ☐ OS map reference ☐ Description

Postal Address Of Premises

Building number or name	Best One Express
Street	4 Fitzroy Street
District	
City or town	Cambridge
County or administrative area	
Postcode	CB1 1EW
Country	United Kingdom

Further Details

Telephone number	
Non-domestic rateable value of premises (£)	20,500

Section 3 of 21

APPLICATION DETAILS

In what capacity are you applying for the premises licence?

- ☒ An individual or individuals
- ☐ A limited company / limited liability partnership
- ☐ A partnership (other than limited liability)
- ☐ An unincorporated association
- ☐ Other (for example a statutory corporation)
- ☐ A recognised club
- ☐ A charity
- ☐ The proprietor of an educational establishment
- ☐ A health service body
- ☐ A person who is registered under part 2 of the Care Standards Act 2000 (c14) in respect of an independent hospital in Wales
- ☐ A person who is registered under Chapter 2 of Part 1 of the Health and Social Care Act 2008 in respect of the carrying on of a regulated activity (within the meaning of that Part) in an independent hospital in England
- ☐ The chief officer of police of a police force in England and Wales

Confirm The Following

- ☒ I am carrying on or proposing to carry on a business which involves the use of the premises for licensable activities
- ☐ I am making the application pursuant to a statutory function
- ☐ I am making the application pursuant to a function discharged by virtue of Her Majesty's prerogative

Section 4 of 21

INDIVIDUAL APPLICANT DETAILS

Applicant Name

Is the name the same as (or similar to) the details given in section one?

- ☒ Yes ☐ No

If "Yes" is selected you can re-use the details from section one, or amend them as required. Select "No" to enter a completely new set of details.

First name

Family name

Is the applicant 18 years of age or older?

- ☒ Yes ☐ No

Continued from previous page...

Current Residential Address

Is the address the same as (or similar to) the address given in section one?

☒ Yes ☐ No

If "Yes" is selected you can re-use the details from section one, or amend them as required. Select "No" to enter a completely new set of details.

Building number or name	<input type="text"/>
Street	<input type="text"/>
District	<input type="text"/>
City or town	<input type="text"/>
County or administrative area	<input type="text"/>
Postcode	<input type="text"/>
Country	<input type="text" value="United Kingdom"/>

Applicant Contact Details

Are the contact details the same as (or similar to) those given in section one?

☒ Yes ☐ No

If "Yes" is selected you can re-use the details from section one, or amend them as required. Select "No" to enter a completely new set of details.

E-mail	<input type="text"/>
Telephone number	<input type="text"/>
Other telephone number	<input type="text"/>
* Date of birth	<input type="text" value="dd"/> <input type="text" value="mm"/> <input type="text" value="yyyy"/>
* Nationality	<input type="text"/>
Right to work share code	<input type="text"/>

[Documents that demonstrate entitlement to work in the UK](#)
[Right to work share code if not submitting scanned documents](#)

Add another applicant

Section 5 of 21

OPERATING SCHEDULE

When do you want the premises licence to start?

<input type="text" value="17"/>	/	<input type="text" value="11"/>	/	<input type="text" value="2021"/>
dd		mm		yyyy

If you wish the licence to be valid only for a limited period, when do you want it to end?

<input type="text"/>	/	<input type="text"/>	/	<input type="text"/>
dd		mm		yyyy

Provide a general description of the premises

Continued from previous page...

For example the type of premises, its general situation and layout and any other information which could be relevant to the licensing objectives. Where your application includes off-supplies of alcohol and you intend to provide a place for consumption of these off-supplies you must include a description of where the place will be and its proximity to the premises.

The premises trades as a small convenience store in Cambridge city centre, and is seeking to offer the sale of alcohol for consumption off the premises. It has become necessary for the applicant to seek additional product ranges to ensure the business has a chance of success in the future. The introduction of a small off sales range will increase the overall basket spend of his regular customers. This application is not made with the intention of pulling in new customers from all over Cambridge, but merely to provide the full convenience store experience to the existing customer base. A basket spend of £8 rather than £4 can be the difference between survival or not. The applicant is aware that the premises falls within the city centre CIA, but is asking, having considered the application that you accept this as an exception to the policy.

If 5,000 or more people are expected to attend the premises at any one time, state the number expected to attend

Section 6 of 21

PROVISION OF PLAYS

[See guidance on regulated entertainment](#)

Will you be providing plays?

☐ Yes ☒ No

Section 7 of 21

PROVISION OF FILMS

[See guidance on regulated entertainment](#)

Will you be providing films?

☐ Yes ☒ No

Section 8 of 21

PROVISION OF INDOOR SPORTING EVENTS

[See guidance on regulated entertainment](#)

Will you be providing indoor sporting events?

☐ Yes ☒ No

Section 9 of 21

PROVISION OF BOXING OR WRESTLING ENTERTAINMENTS

[See guidance on regulated entertainment](#)

Will you be providing boxing or wrestling entertainments?

☐ Yes ☒ No

Section 10 of 21

PROVISION OF LIVE MUSIC

[See guidance on regulated entertainment](#)

Will you be providing live music?

☐ Yes ☒ No

Section 11 of 21

Continued from previous page...			
PROVISION OF RECORDED MUSIC			
See guidance on regulated entertainment Will you be providing recorded music? <input type="radio"/> Yes <input checked="" type="radio"/> No			
Section 12 of 21			
PROVISION OF PERFORMANCES OF DANCE			
See guidance on regulated entertainment Will you be providing performances of dance? <input type="radio"/> Yes <input checked="" type="radio"/> No			
Section 13 of 21			
PROVISION OF ANYTHING OF A SIMILAR DESCRIPTION TO LIVE MUSIC, RECORDED MUSIC OR PERFORMANCES OF DANCE			
See guidance on regulated entertainment Will you be providing anything similar to live music, recorded music or performances of dance? <input type="radio"/> Yes <input checked="" type="radio"/> No			
Section 14 of 21			
LATE NIGHT REFRESHMENT			
Will you be providing late night refreshment? <input type="radio"/> Yes <input checked="" type="radio"/> No			
Section 15 of 21			
SUPPLY OF ALCOHOL			
Will you be selling or supplying alcohol? <input checked="" type="radio"/> Yes <input type="radio"/> No			
Standard Days And Timings			
MONDAY		Start <input type="text" value="10:00"/> End <input type="text" value="22:00"/> Start <input type="text"/> End <input type="text"/>	Give timings in 24 hour clock. (e.g., 16:00) and only give details for the days of the week when you intend the premises to be used for the activity.
TUESDAY		Start <input type="text" value="10:00"/> End <input type="text" value="22:00"/> Start <input type="text"/> End <input type="text"/>	
WEDNESDAY		Start <input type="text" value="10:00"/> End <input type="text" value="22:00"/> Start <input type="text"/> End <input type="text"/>	

Continued from previous page...

THURSDAY

Start

End

Start

End

FRIDAY

Start

End

Start

End

SATURDAY

Start

End

Start

End

SUNDAY

Start

End

Start

End

Will the sale of alcohol be for consumption:

☐ On the premises ☒ Off the premises ☐ Both

If the sale of alcohol is for consumption on the premises select on, If the sale of alcohol is for consumption away from the premises select off. If the sale of alcohol is for consumption on the premises and away from the premises select both.

State any seasonal variations

For example (but not exclusively) where the activity will occur on additional days during the summer months.

n/a

Non-standard timings. Where the premises will be used for the supply of alcohol at different times from those listed in the column on the left, list below

For example (but not exclusively), where you wish the activity to go on longer on a particular day e.g. Christmas Eve.

n/a

State the name and details of the individual whom you wish to specify on the licence as premises supervisor

Name

First name

Family name

* required information

Section 1 of 21

You can save the form at any time and resume it later. You do not need to be logged in when you resume.

System reference	Not Currently In Use	This is the unique reference for this application generated by the system.
Your reference	sgl:2108	You can put what you want here to help you track applications if you make lots of them. It is passed to the authority.

Are you an agent acting on behalf of the applicant?

☒ Yes ☐ No

Put "no" if you are applying on your own behalf or on behalf of a business you own or work for.

Applicant Details

* First name Dillip

* Family name Bathula

* E-mail [REDACTED]

Main telephone number [REDACTED]

Include country code.

Other telephone number [REDACTED]

☒ Indicate here if the applicant would prefer not to be contacted by telephone

Is the applicant:

☐ Applying as a business or organisation, including as a sole trader
☒ Applying as an individual

A sole trader is a business owned by one person without any special legal structure. Applying as an individual means the applicant is applying so the applicant can be employed, or for some other personal reason, such as following a hobby.

Continued from previous page...

MONDAY

Start

End

Start

End

Give timings in 24 hour clock.
(e.g., 16:00) and only give details for the days
of the week when you intend the premises
to be used for the activity.

TUESDAY

Start

End

Start

End

WEDNESDAY

Start

End

Start

End

THURSDAY

Start

End

Start

End

FRIDAY

Start

End

Start

End

SATURDAY

Start

End

Start

End

SUNDAY

Start

End

Start

End

State any seasonal variations

For example (but not exclusively) where the activity will occur on additional days during the summer months.

n/a

Non standard timings. Where you intend to use the premises to be open to the members and guests at different times from those listed in the column on the left, list below

For example (but not exclusively), where you wish the activity to go on longer on a particular day e.g. Christmas Eve.

n/a

Section 18 of 21

LICENSING OBJECTIVES

Describe the steps you intend to take to promote the four licensing objectives:

a) General – all four licensing objectives (b,c,d,e)

List here steps you will take to promote all four licensing objectives together.

All staff to be trained to a level commensurate with their duties with regard to the sale of alcohol, and will be retrained every six months. The training should be clearly documented and signed and dated by both the trainer and the member of staff receiving it. The documentation shall be available for inspection on request by an authorised officer of the Licensing Authority or a constable.

b) The prevention of crime and disorder

CCTV will be provided in the form of a recordable system, capable of providing pictures of EVIDENTIAL QUALITY in all lighting conditions particularly facial recognition.
Cameras shall encompass all ingress and egress to the premises, fire exits, outside areas, and all areas where the sale/ supply of alcohol occurs.
Equipment MUST be maintained in good working order, be correctly time and date stamped, recordings MUST be kept in date order, numbered sequentially and kept for a period of 31 days and handed to Police on demand.
The Premises Licence Holder must ensure at all times a DPS or appointed member of staff is capable and competent at downloading CCTV footage in a recordable format EITHER DISC or VHS to the Police/Local Authority on demand.
The Recording equipment and tapes/discs shall be kept in a secure environment under the control of the DPS or other responsible named individual. An operational daily log report must be maintained endorsed by signature, indicating the system has been checked and is compliant, in the event of any failings actions taken are to be recorded.
In the event of technical failure of the CCTV equipment the Premises Licence holder/DPS MUST report the failure to the Police immediately.
All Spirits to be displayed behind the counter only.

An Incident log shall be kept at the premises, and made available on request to an authorised officer of the Council or the Police. It must be completed within 24 hours of the incident and will record the following:

- a) all crimes reported to the venue
- b) all ejections of patrons
- c) any complaints received concerning crime and disorder
- d) any incidents of disorder
- e) all seizures of drugs or offensive weapons
- f) any faults in the CCTV system, searching equipment or scanning equipment
- g) any refusal of the sale of alcohol including date, time and name of staff member
- h) any visit by a relevant authority or emergency service.

c) Public safety

Staff will be trained to be alert to any potential danger to customers and react accordingly. If they are unable to quickly defuse the situation without risk to customer or staff, then they are instructed to call the police. All relevant fire procedures are in place for a premise of this size.

d) The prevention of public nuisance

Customers will be reminded by way of a notice at the entrance/ exit door to please leave the premises quietly and have consideration for the neighbouring properties. sufficient litter bins will be provided to allow the customers to deposit their waste/ rubbish in the correct manner.

Continued from previous page...

e) The protection of children from harm

The premises shall operate a Challenge 25 Policy. Such policy shall be written down and kept at the premises. The policy shall be produced on demand of an authorised person' (as defined by Section 13 of the Licensing Act 2003) or the police or an authorised Trading Standards Officer of the Council. Prominent, clear and legible signage (In not less than 32 font bold) shall also be displayed at all entrances to the premises as well as at, at least one location behind any counter advertising the scheme operated.

A written register of refusals will be kept including a description of the people who have been unable to provide required identification to prove their age. Such records shall be kept for a period of 12 months and will be collected on a daily basis by the Designated Premises Supervisor and produced to the police or an 'authorised person' (as defined by Section 13 of the Licensing Act 2003) or an authorised Trading Standards Officer of the Council on demand.

Section 19 of 21

NOTES ON DEMONSTRATING ENTITLEMENT TO WORK IN THE UK

Continued from previous page...

Entitlement to work/immigration status for individual applicants and applications from partnerships which are not limited liability partnerships:

A licence may not be held by an individual or an individual in a partnership who is resident in the UK who:

- does not have the right to live and work in the UK; or
- is subject to a condition preventing him or her from doing work relating to the carrying on of a licensable activity.

Any premises licence issued in respect of an application made on or after 6 April 2017 will become invalid if the holder ceases to be entitled to work in the UK.

Applicants must demonstrate that they have an entitlement to work in the UK and are not subject to a condition preventing them from doing work relating to the carrying on of a licensable activity. They do this in one of two ways: 1) by providing with this application copies or scanned copies of the documents listed below (which do not need to be certified), or 2) by providing their 'share code' to enable the licensing authority to carry out a check using the Home Office online right to work checking service (see below).

Documents which demonstrate entitlement to work in the UK

- An expired or current passport showing the holder, or a person named in the passport as the child of the holder, is a British citizen or a citizen of the UK and Colonies having the right of abode in the UK [please see note below about which sections of the passport to copy].
- An expired or current passport or national identity card showing the holder, or a person named in the passport as the child of the holder, is a national of a European Economic Area country or Switzerland.
- A Registration Certificate or document certifying permanent residence issued by the Home Office to a national of a European Economic Area country or Switzerland.
- A Permanent Residence Card issued by the Home Office to the family member of a national of a European Economic Area country or Switzerland.
- A **current** Biometric Immigration Document (Biometric Residence Permit) issued by the Home Office to the holder indicating that the person named is allowed to stay indefinitely in the UK, or has no time limit on their stay in the UK.
- A **current** passport endorsed to show that the holder is exempt from immigration control, is allowed to stay indefinitely in the UK, has the right of abode in the UK, or has no time limit on their stay in the UK.
- A **current** Immigration Status Document issued by the Home Office to the holder with an endorsement indicating that the named person is allowed to stay indefinitely in the UK or has no time limit on their stay in the UK, **when produced in combination with** an official document giving the person's permanent National Insurance number and their name issued by a Government agency or a previous employer.
- A birth or adoption certificate issued in the UK, **when produced in combination with** an official document giving the person's permanent National Insurance number and their name issued by a Government agency or a previous employer.
- A birth or adoption certificate issued in the Channel Islands, the Isle of Man or Ireland **when produced in combination with** an official document giving the person's permanent National Insurance number and their name issued by a Government agency or a previous employer.
- A certificate of registration or naturalisation as a British citizen, **when produced in combination with** an official document giving the person's permanent National Insurance number and their name issued by a Government agency or a previous employer.

Continued from previous page...

- A **current** passport endorsed to show that the holder is allowed to stay in the UK and is currently allowed to work and is not subject to a condition preventing the holder from doing work relating to the carrying on of a licensable activity.
- A **current** Biometric Immigration Document (Biometric Residence Permit) issued by the Home Office to the holder which indicates that the named person can currently stay in the UK and is allowed to work relating to the carrying on of a licensable activity.
- A **current** Residence Card issued by the Home Office to a person who is not a national of a European Economic Area state or Switzerland but who is a family member of such a national or who has derivative rights of residence.
- A **current** Immigration Status Document containing a photograph issued by the Home Office to the holder with an endorsement indicating that the named person may stay in the UK, and is allowed to work and is not subject to a condition preventing the holder from doing work relating to the carrying on of a licensable activity **when produced in combination with** an official document giving the person's permanent National Insurance number and their name issued by a Government agency or a previous employer.
- A Certificate of Application, **less than 6 months old**, issued by the Home Office under regulation 18(3) or 20(2) of the Immigration (European Economic Area) Regulations 2016, to a person who is not a national of a European Economic Area state or Switzerland but who is a family member of such a national or who has derivative rights of residence.
- Reasonable evidence that the person has an outstanding application to vary their permission to be in the UK with the Home Office such as the Home Office acknowledgement letter or proof of postage evidence, or reasonable evidence that the person has an appeal or administrative review pending on an immigration decision, such as an appeal or administrative review reference number.
- Reasonable evidence that a person who is not a national of a European Economic Area state or Switzerland but who is a family member of such a national or who has derivative rights of residence in exercising treaty rights in the UK including:-
 - evidence of the applicant's own identity – such as a passport,
 - evidence of their relationship with the European Economic Area family member – e.g. a marriage certificate, civil partnership certificate or birth certificate, and
 - evidence that the European Economic Area national has a right of permanent residence in the UK or is one of the following if they have been in the UK for more than 3 months:
 - (i) working e.g. employment contract, wage slips, letter from the employer,
 - (ii) self-employed e.g. contracts, invoices, or audited accounts with a bank,
 - (iii) studying e.g. letter from the school, college or university and evidence of sufficient funds; or
 - (iv) self-sufficient e.g. bank statements.

Family members of European Economic Area nationals who are studying or financially independent must also provide evidence that the European Economic Area national and any family members hold comprehensive sickness insurance in the UK. This can include a private medical insurance policy, an EHIC card or an S1, S2 or S3 form.

Original documents must not be sent to licensing authorities. If the document copied is a passport, a copy of the following pages should be provided:-

- (i) any page containing the holder's personal details including nationality;
- (ii) any page containing the holder's photograph;
- (iii) any page containing the holder's signature;
- (iv) any page containing the date of expiry; and
- (v) any page containing information indicating the holder has permission to enter or remain in the UK and is permitted to work.

Continued from previous page...

If the document is not a passport, a copy of the whole document should be provided.

Your right to work will be checked as part of your licensing application and this could involve us checking your immigration status with the Home Office. We may otherwise share information with the Home Office. Your licence application will not be determined until you have complied with this guidance.

Home Office online right to work checking service

As an alternative to providing a copy of the documents listed above, applicants may demonstrate their right to work by allowing the licensing authority to carry out a check with the Home Office online right to work checking service.

To demonstrate their right to work via the Home Office online right to work checking service, applicants should include in this application their 9-digit share code (provided to them upon accessing the service at <https://www.gov.uk/prove-right-to-work>) which, along with the applicant's date of birth (provided within this application), will allow the licensing authority to carry out the check.

In order to establish the applicant's right to work, the check will need to indicate that the applicant is allowed to work in the United Kingdom and is not subject to a condition preventing them from doing work relating to the carrying on of a licensable activity.

An online check will not be possible in all circumstances because not all applicants will have an immigration status that can be checked online. The Home Office online right to work checking service sets out what information and/or documentation applicants will need in order to access the service. Applicants who are unable to obtain a share code from the service should submit copy documents as set out above.

Section 20 of 21

NOTES ON REGULATED ENTERTAINMENT

Continued from previous page...

In terms of specific **regulated entertainments** please note that:

- Plays: no licence is required for performances between 08.00 and 23.00 on any day, provided that the audience does not exceed 500.
- Films: no licence is required for 'not-for-profit' film exhibition held in community premises between 08.00 and 23.00 on any day provided that the audience does not exceed 500 and the organiser (a) gets consent to the screening from a person who is responsible for the premises; and (b) ensures that each such screening abides by age classification ratings.
- Indoor sporting events: no licence is required for performances between 08.00 and 23.00 on any day, provided that the audience does not exceed 1000.
- Boxing or Wrestling Entertainment: no licence is required for a contest, exhibition or display of Greco-Roman wrestling, or freestyle wrestling between 08.00 and 23.00 on any day, provided that the audience does not exceed 1000. Combined fighting sports – defined as a contest, exhibition or display which combines boxing or wrestling with one or more martial arts – are licensable as a boxing or wrestling entertainment rather than an indoor sporting event.
- Live music: no licence permission is required for:
 - o a performance of unamplified live music between 08.00 and 23.00 on any day, on any premises.
 - o a performance of amplified live music between 08.00 and 23.00 on any day on premises authorised to sell alcohol for consumption on those premises, provided that the audience does not exceed 500.
 - o a performance of amplified live music between 08.00 and 23.00 on any day, in a workplace that is not licensed to sell alcohol on those premises, provided that the audience does not exceed 500.
 - o a performance of amplified live music between 08.00 and 23.00 on any day, in a church hall, village hall, community hall, or other similar community premises, that is not licensed by a premises licence to sell alcohol, provided that (a) the audience does not exceed 500, and (b) the organiser gets consent for the performance from a person who is responsible for the premises.
 - o a performance of amplified live music between 08.00 and 23.00 on any day, at the non-residential premises of (I) a local authority, or (II) a school, or (III) a hospital, provided that (a) the audience does not exceed 500, and (b) the organiser gets consent for the performance on the relevant premises from: (I) the local authority concerned, or (II) the school or (III) the health care provider for the hospital.
- Recorded Music: no licence permission is required for:
 - o any playing of recorded music between 08.00 and 23.00 on any day on premises authorised to sell alcohol for consumption on those premises, provided that the audience does not exceed 500.
 - o any playing of recorded music between 08.00 and 23.00 on any day, in a church hall, village hall, community hall, or other similar community premises, that is not licensed by a premises licence to sell alcohol, provided that (a) the audience does not exceed 500, and (b) the organiser gets consent for the performance from a person who is responsible for the premises.
 - o any playing of recorded music between 08.00 and 23.00 on any day, at the non-residential premises of (I) a local authority, or (II) a school, or (III) a hospital, provided that (a) the audience does not exceed 500, and (b) the organiser gets consent for the performance on the relevant premises from: (I) the local authority concerned, or (II) the school proprietor or (III) the health care provider for the hospital.

Continued from previous page...

- Dance: no licence is required for performances between 08.00 and 23.00 on any day, provided that the audience does not exceed 500. However, a performance which amounts to adult entertainment remains licensable.
- Cross activity exemptions: no licence is required between 08.00 and 23.00 on any day, with no limit on audience size for:
 - o any entertainment taking place on the premises of the local authority where the entertainment is provided by or on behalf of the local authority;
 - o any entertainment taking place on the hospital premises of the health care provider where the entertainment is provided by or on behalf of the health care provider;
 - o any entertainment taking place on the premises of the school where the entertainment is provided by or on behalf of the school proprietor; and
 - o any entertainment (excluding films and a boxing or wrestling entertainment) taking place at a travelling circus, provided that (a) it takes place within a moveable structure that accommodates the audience, and (b) that the travelling circus has not been located on the same site for more than 28 consecutive days.

Section 21 of 21

PAYMENT DETAILS

This fee must be paid to the authority. If you complete the application online, you must pay it by debit or credit card.

Premises Licence Fees are determined by the non-domestic rateable value of the premises. To find out a premises non domestic rateable value go to the Valuation Office Agency site at http://www.voa.gov.uk/business_rates/Index.htm

The national scale of fees is set out below and also available on our website: <http://www.cambridge.gov.uk/ccm/content/ehws/licensing/fees.en> Please enter and pay the appropriate fee. If you are uncertain of the fee enter 0 in the amount field and the City Council will contact you to advise you of the fee. Please note the application will not be processed until the correct fee has been paid.

Band A - No RV to £4300 £100.00

Band B - £4301 to £33000 £190.00

Band C - £33001 to £87000 £315.00

Band D - £87001 to £125000 £450.00*

Band E - £125001 and over £635.00*

*If the premises rateable value is in Bands D or E and the premises is primarily used for the consumption of alcohol on the premises then you are required to pay a higher fee

Band D - £87001 to £125000 £900.00

Band E - £125001 and over £1,905.00

There is an exemption from the payment of fees in relation to the provision of regulated entertainment at church halls, chapel halls or premises of a similar nature, village halls, parish or community halls, or other premises of a similar nature. The costs associated with these licences will be met by central Government. If, however, the licence also authorises the use of the premises for the supply of alcohol or the provision of late night refreshment, a fee will be required.

Schools and sixth form colleges are exempt from the fees associated with the authorisation of regulated entertainment where the entertainment is provided by and at the school or college and for the purposes of the school or college.

If you operate a large event you are subject to ADDITIONAL fees based upon the number in attendance at any one time

Capacity 5000-9999 £1,000.00

Capacity 10000 -14999 £2,000.00

Capacity 15000-19999 £4,000.00

Capacity 20000-29999 £8,000.00

Capacity 30000-39999 £16,000.00

Capacity 40000-49999 £24,000.00

Capacity 50000-59999 £32,000.00

Capacity 60000-69999 £40,000.00

Capacity 70000-79999 £48,000.00

Capacity 80000-89999 £56,000.00

Capacity 90000 and over £64,000.00

* Fee amount (£)

190.00

DECLARATION

* I/we understand it is an offence, liable on conviction to a fine up to level 5 on the standard scale, under section 158 of the Licensing Act 2003, to make a false statement in or in connection with this application.

[Applicable to individual applicants only, including those in a partnership which is not a limited liability partnership] I

* understand I am not entitled to be issued with a licence if I do not have the entitlement to live and work in the UK (or if I am subject to a condition preventing me from doing work relating to the carrying on of a licensable activity) and that my licence will become invalid if I cease to be entitled to live and work in the UK (please read guidance note 15).

The DPS named in this application form is entitled to work in the UK (and is not subject to conditions preventing him or

* her from doing work relating to a licensable activity) and I have seen a copy of his or her proof of entitlement to work, if appropriate (please see note 15).

☒ Ticking this box indicates you have read and understood the above declaration

This section should be completed by the applicant, unless you answered "Yes" to the question "Are you an agent acting on behalf of the applicant?"

* Full name

* Capacity

* Date / /
dd mm yyyy

[Add another signatory](#)

Once you're finished you need to do the following:

1. Save this form to your computer by clicking file/save as...

2. Go back to <https://www.gov.uk/apply-for-a-licence/premises-licence/cambridge/apply-1> to upload this file and continue with your application.

Don't forget to make sure you have all your supporting documentation to hand.

IT IS AN OFFENCE LIABLE TO SUMMARY CONVICTION TO A FINE OF ANY AMOUNT UNDER SECTION 158 OF THE LICENSING ACT 2003, TO MAKE A FALSE STATEMENT IN OR IN CONNECTION WITH THIS APPLICATION

IT IS AN OFFENCE UNDER SECTION 24B OF THE IMMIGRATION ACT 1971 FOR A PERSON TO WORK WHEN THEY KNOW, OR HAVE REASONABLE CAUSE TO BELIEVE, THAT THEY ARE DISQUALIFIED FROM DOING SO BY REASON OF THEIR IMMIGRATION STATUS. THOSE WHO EMPLOY AN ADULT WITHOUT LEAVE OR WHO IS SUBJECT TO CONDITIONS AS TO EMPLOYMENT WILL BE LIABLE TO A CIVIL PENALTY UNDER SECTION 15 OF THE IMMIGRATION, ASYLUM AND NATIONALITY ACT 2006 AND PURSUANT TO SECTION 21 OF THE SAME ACT, WILL BE COMMITTING AN OFFENCE WHERE THEY DO SO IN THE KNOWLEDGE, OR WITH REASONABLE CAUSE TO BELIEVE, THAT THE EMPLOYEE IS DISQUALIFIED

OFFICE USE ONLY

Applicant reference number	<input type="text" value="sgl:2108"/>
Fee paid	<input type="text"/>
Payment provider reference	<input type="text"/>
ELMS Payment Reference	<input type="text"/>
Payment status	<input type="text"/>
Payment authorisation code	<input type="text"/>
Payment authorisation date	<input type="text"/>
Date and time submitted	<input type="text"/>
Approval deadline	<input type="text"/>
Error message	<input type="text"/>
Is Digitally signed	<input type="checkbox"/>

[1](#) [2](#) [3](#) [4](#) [5](#) [6](#) [7](#) [8](#) [9](#) [10](#) [11](#) [12](#) [13](#) [14](#) [15](#) [16](#) [17](#) [18](#) [19](#) [20](#) [21](#) [Next >](#)

This page is intentionally left blank

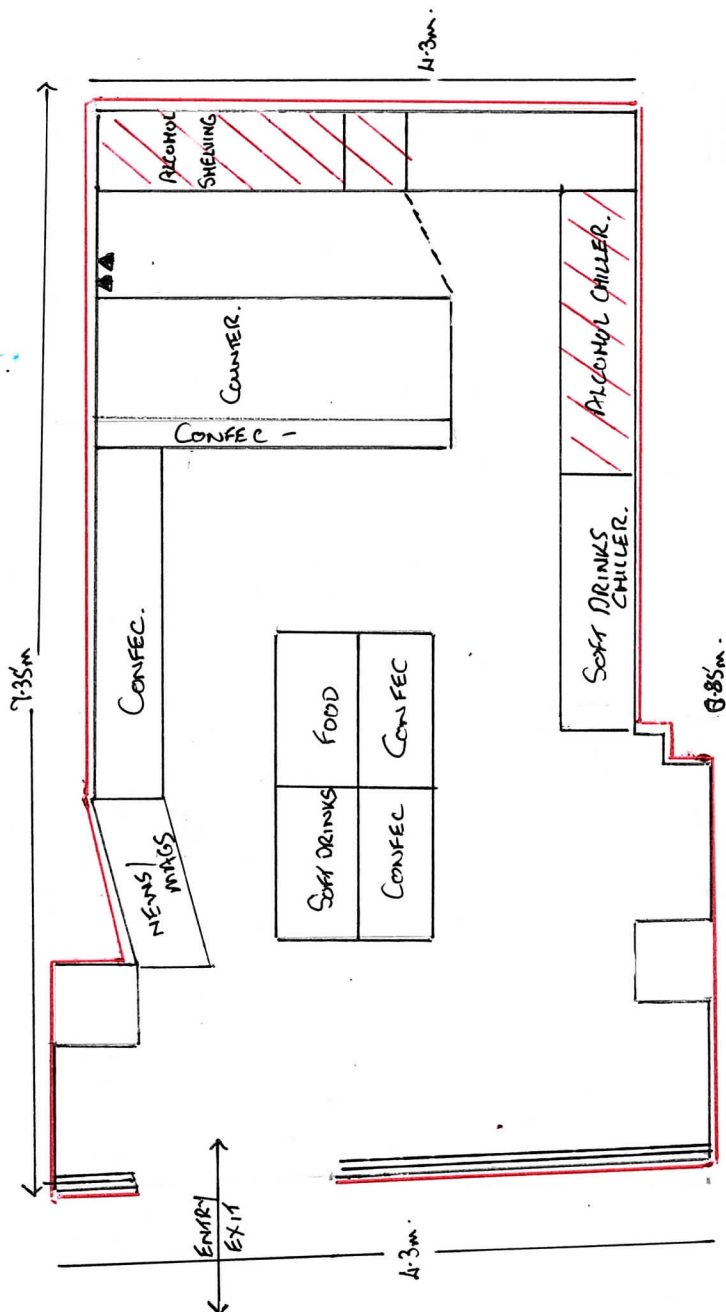

▲ FIRE EXTINGUISHER.

/// LICENSABLE DISPLAY

BEST ONE EXPRESS
4 FITZROY STREET
CAMBRIDGE
CB1 1EW.

This page is intentionally left blank

Appendix C – Conditions agreed with the Police

1. All alcohol to be displayed behind a secure counter (not available for self service).
2. Only beer, cider and lager with a maximum ABV content of 5.5% to be sold, except for specialist branded premium priced products.
3. A member of staff shall be on the shop floor at any time a customer is within the shop.
4. Audible door chime to notify a member of staff when customer enters/exits store.
5. There shall be no advertising of alcohol products in either the shop front windows or the exterior of the premises.
6. Times of when alcohol can be sold will be on display within the premises.
7. All staff shall be trained to record refusals of sales of alcohol in a refusals register.
8. All relevant staff are appropriately, and well trained about: the requirements for persons' identification; establishing age; the adopted Nationally recognised Age Restricted Policy; not serving alcohol to intoxicated persons; asking customers to use premises in an orderly and respectful manner; and adhering to Environmental Health requirements. Records of such training must be made available, on demand, to any authorised officer.
9. It is considered that for the nature of the operation door supervisors will not be required at all times, however a liaison system with the police licensing officer set up, whereby on certain occasions a year and where it is considered necessary a security officer/doorman will be employed by the licence holder based on a risk assessment and having regard to advice from the police.
10. The person nominated as the DPS will join the Cambac Nightsafe/Pub watch scheme and support its aims and objectives. This includes support of its agreed banning policy and attending meetings; personally or by sending an authorised representative of the venue. The condition is only binding whilst the Nightsafe/Pub watch scheme is in existence.

11. A written or electronic log will be kept of all refusals including refusals to sell alcohol. The Premises Licence holder shall ensure that refusals log is checked on a regular basis. The log will be kept and maintained at the premises and will be available at all times whilst the premises are open for inspection immediately upon request by Cambridgeshire Police and any responsible authority.
12. The DPS or relevant person will actively operate "Challenge 25 Policy" This will include a voluntary agreement to only accept identity cards with the "Pass" accreditation; passports; photo ID driving licences; any National identity card as ruled by any British Court as a bona-fide recognised form of identification; or any future identification card as approved by central government; as bona-fide recognised forms of identification.
13. No customers carrying opened bottles of alcoholic drink upon entry shall be admitted to premises at any time they are open to the public.
14. No single cans or bottles of beer, lager, cider to be sold.
15. Sales area to be no more than 10% of premises to be used for alcohol.
16. Till prompts shall automatically prompt staff to ask for age verification identification when presented with an alcohol sale.

Appendix C – Best One Express Representation Redacted

Subject: Re: Application received under the Licensing Act 2003 for a new Premises Licence – Best One Express

I would like to make an objection to this application.

The location is within the city centre cumulative impact area. I am objecting because the application does not address issues of cumulative impact, as it should do under 4.9 of the cumulative impact assessment, which indicates a lack of awareness of the authority's policy regime. It does ask for "an exception" but no reason for an exception is provided except economic need, which as far as I am aware is not a relevant factor, although I naturally have sympathy.

I am also objecting because I consider that the application, even with the conditions recommended by the Police, will leave the business ill-equipped to deliver on the licensing objectives.

I am obliged to highlight that 'cumulative' in the very local sense means next door to Waitrose, which staffs access and egress from its licensed store with a uniformed guard which helped to gain them their licence for alcohol sales. The guard role there is active in regulating access and intervening on egress from the premises. In this context, in the absence of a guard at 4 Fitzroy Street - indeed with only one staff member present and s/he not located between the open shelving for alcohol and street access, the premises will immediately be identified as the go-to place for those looking for unprotected alcohol.

In my opinion this business is unfortunately not proposing the resources necessary to address the local situation in a properly considered attempt to meet any of the licensing objectives.

The location is 50 metres from the Willow Walk hostel for the highest needs homeless people, who typically are suffering from addictions or mental ill health or both. Fitzroy Street is the regular location of beggars and rough sleepers. The confectionary merchandise of the shop itself draws children on the school run to St Mathews and Park Street Primary Schools and Parkside Community College. These are the most sensitive and at times pressurised and volatile conditions into which to introduce a further outlet for alcohol sales with lower than the prevailing standards of security.

This page is intentionally left blank