

This page is intentionally left blank

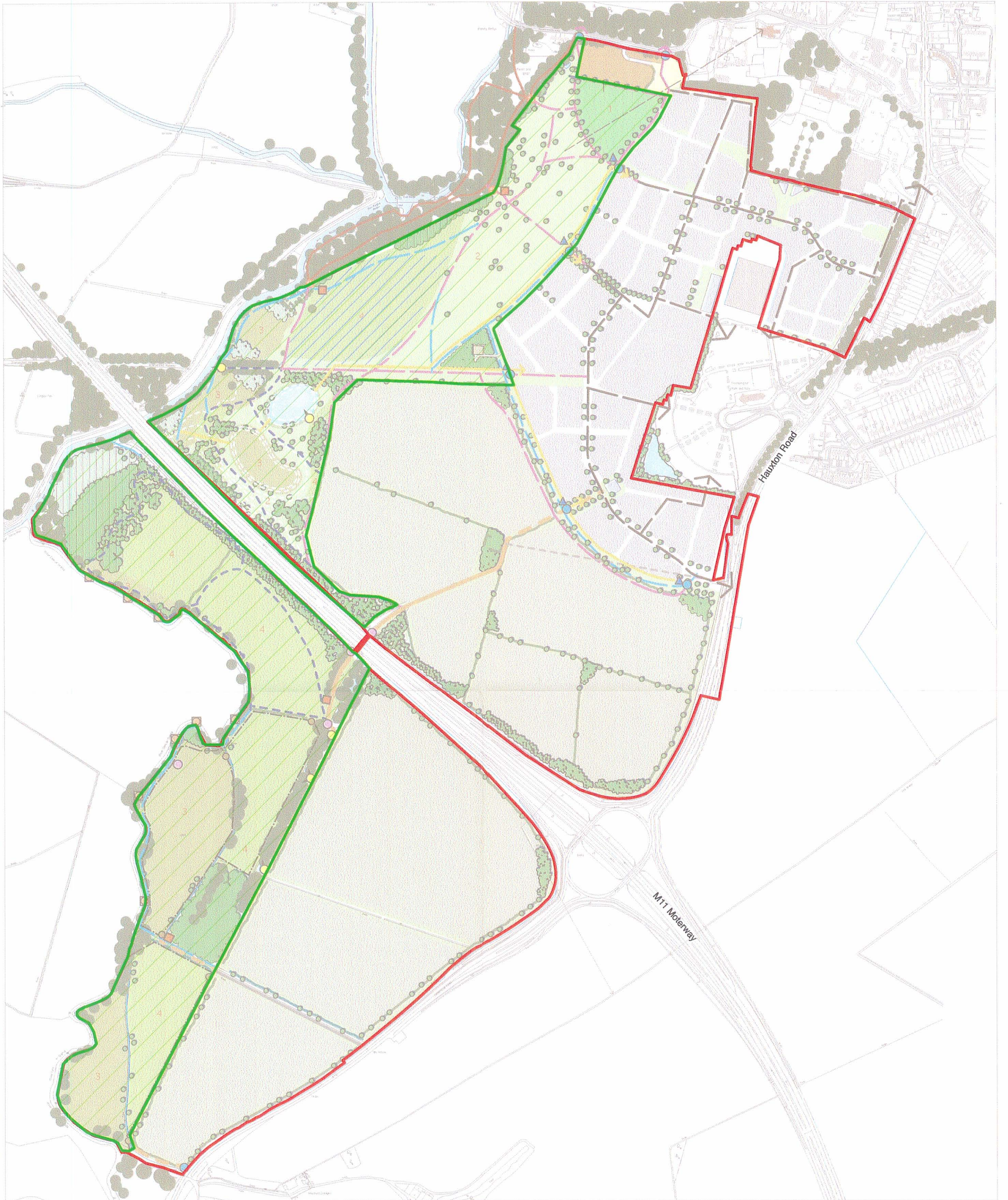

- Combined application boundary
- Reserve matter submission - country park

Based upon the Ordnance Survey Supermap map with the permission of the Ordnance Survey on behalf of the Ministry of Defence. Copyright Terence O'Rourke Ltd Licence no. AL10001826

0 100 200 300m

TRUMPINGTON MEADOWS - RESERVE MATTER COMBINED BOUNDARY

TRUMPINGTON MEADOWS LAND CO LTD



date: JULY 2010
scale: 1:5000@A2
drg no.: 173601M/P/001

Terence O'Rourke Ltd
creating successful environments

© Terence O'Rourke

This page is intentionally left blank

21/04795/FUL

Retail Units Hobson's Square, Clay Farm, Trumpington
Drawing Pack

Proposed development

- Amalgamation of two of the retail units (consented within parcel 8B under reserved matters approval 15/0844/REM), to create a single convenience store, amendments to the servicing layby and details of operating hours for the retail units, at Parcel 8B of the Clay Farm Site

Location Plan

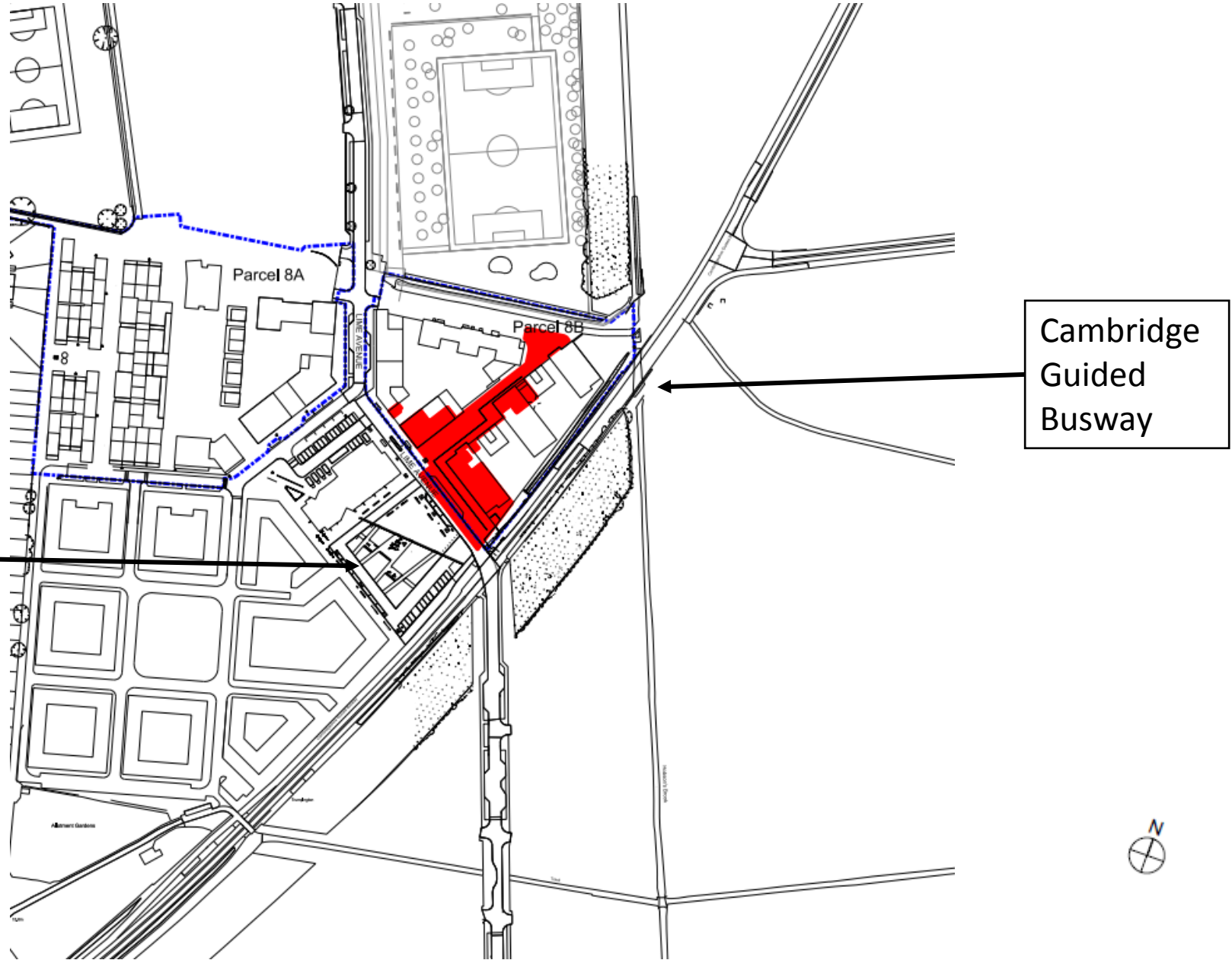

Site Plan

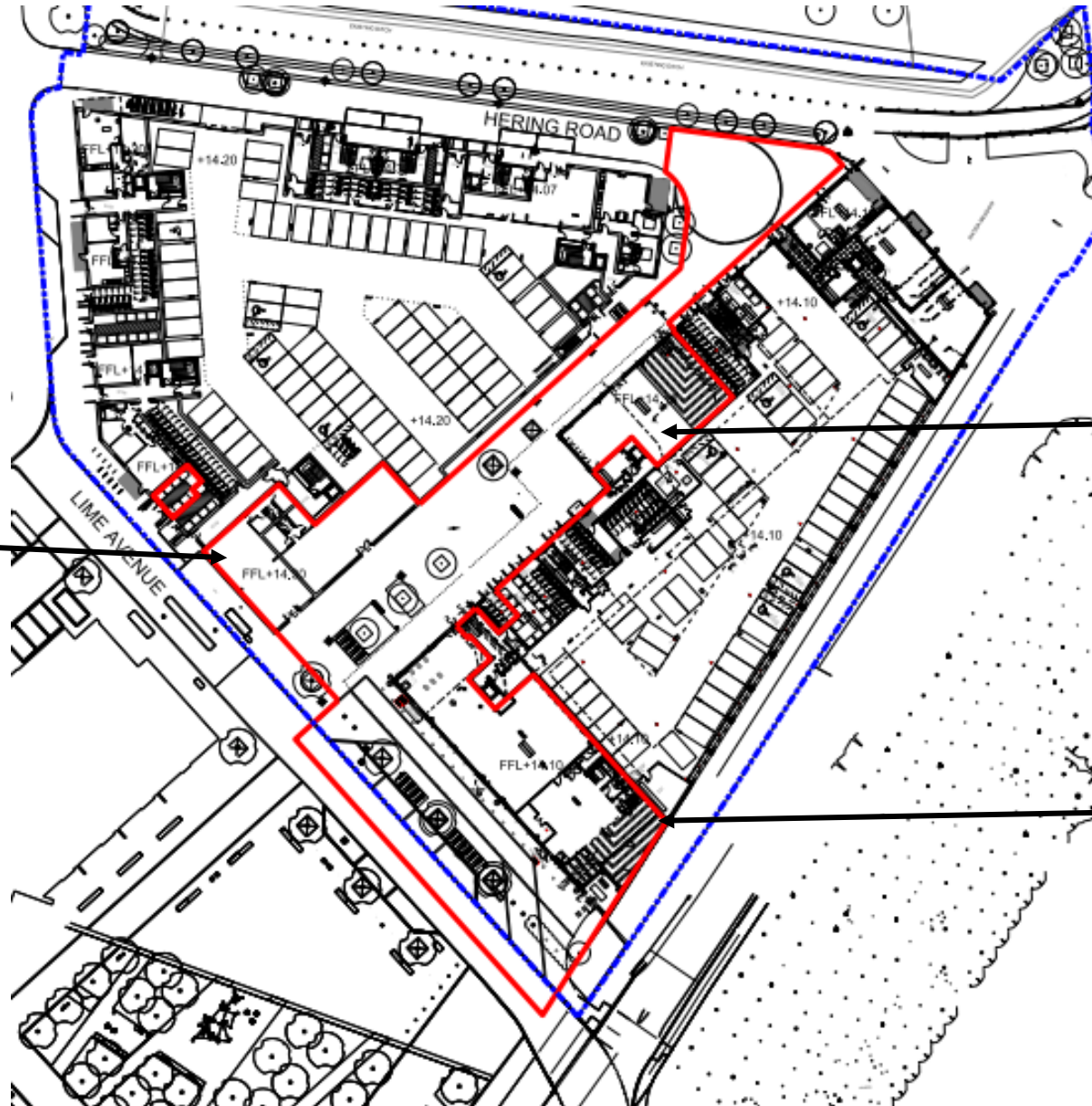

Pages
8

Retail units
1 and 2

Restaurant /
cafe

Proposed
convenience
store

Elevations



01

Elevation 1

South west elevation facing Hobson's Square

This page is intentionally left blank