

**CAMBRIDGE CITY COUNCIL –  
SOUTH AREA COMMITTEE 10<sup>th</sup> DECEMBER 2009**

**4.0 EXISTING SCHEMES REQUIRING DECISIONS**

**4.2 Grantchester Road traffic calming features**

**Consultation Responses**

The closing date for responses was 7<sup>th</sup> December so the analysis of responses is, of necessity, presented as subsidiary notes.

Approximately 250 sets of consultation documentation; (see Appendix A); were delivered to local residents and stakeholders; the distribution area is shown in Plan 1 appended to these notes. 52 responses were returned.

The breakdown of the responses and comments made is given in Appendix B to these notes.

Responses show clear concern about the speed and volume of traffic, and about parking / visibility issues.

It is clear that there is majority support for the ‘gateway’ proposals outlined in the consultation documentation.

There is significant concern about the visibility problems caused by parked cars in Grantchester Road, in the vicinity of the Fulbrooke Road and Selwyn Road junctions.

However, the introduction of waiting restrictions or prohibitions would cause serious problems for many residents as few of the properties in the immediate vicinity of these junctions have off-street parking facilities.

The removal of parked cars from the carriageway would also encourage increased traffic speed; the carriageway width reduction caused by the parked cars serves to some extent as traffic calming.

The introduction of waiting restrictions or prohibitions would probably require the implementation of further traffic calming measures.

It is recommended that, if the ‘gateway’ is implemented, the traffic situation is monitored for a year, after which consideration be given to undertaking a second public consultation as to whether further traffic calming measures are required.

# PLAN 1

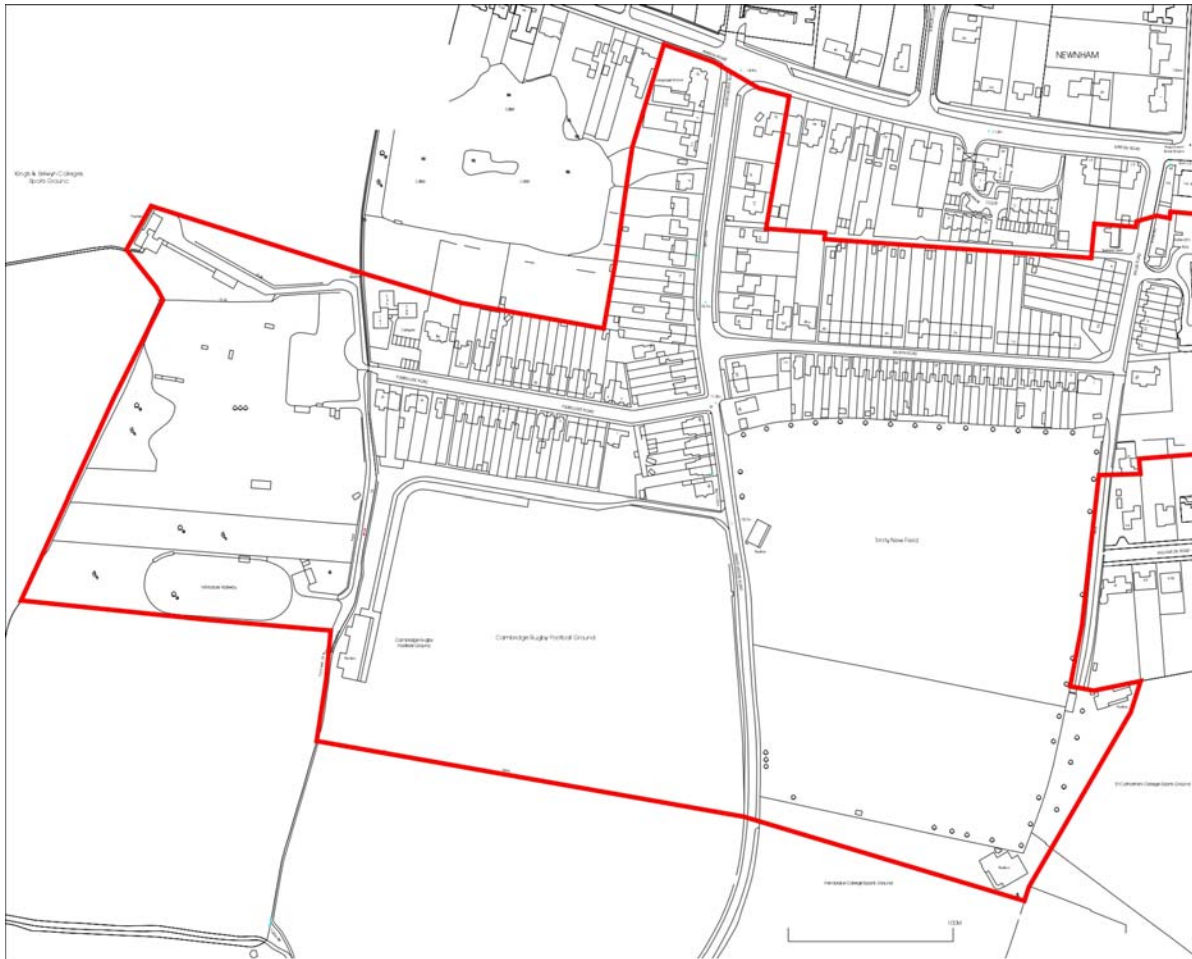

## APPENDIX A

### WHAT IS PROPOSED AND WHY ?

Residents of Grantchester Road and the adjoining roads have expressed concern about the difficulty of safely crossing Grantchester Road, especially at peak traffic times.

The view has been expressed that traffic coming from Grantchester and entering Newnham does not slow down sufficiently, despite the 30 mph restriction signs near the rugby club entrance.

We have been asked to suggest possible solutions and we feel that a first step might be to introduce a 'gateway' feature where the 30 mph restriction starts.

This would take the form of a priority chicane, where traffic entering the city would have to give way to traffic in the opposite direction, and negotiate a road narrowing which would block the inbound lane. An inbound cycle bypass would be provided to allow cyclists to avoid the narrowing.

Overleaf is a drawing of the proposed arrangements.

We would like your views concerning traffic problems in Grantchester Road and the proposal that we are putting forward.

Please complete the reply-paid questionnaire card enclosed with this leaflet and post it back to us, to arrive not later than 07/12/09.

If you have any queries you can phone John Isherwood at 01223-457392.



### GRANTCHESTER ROAD TRAFFIC CALMING GATEWAY PROPOSALS

Residents' &  
Stakeholders'  
Consultation

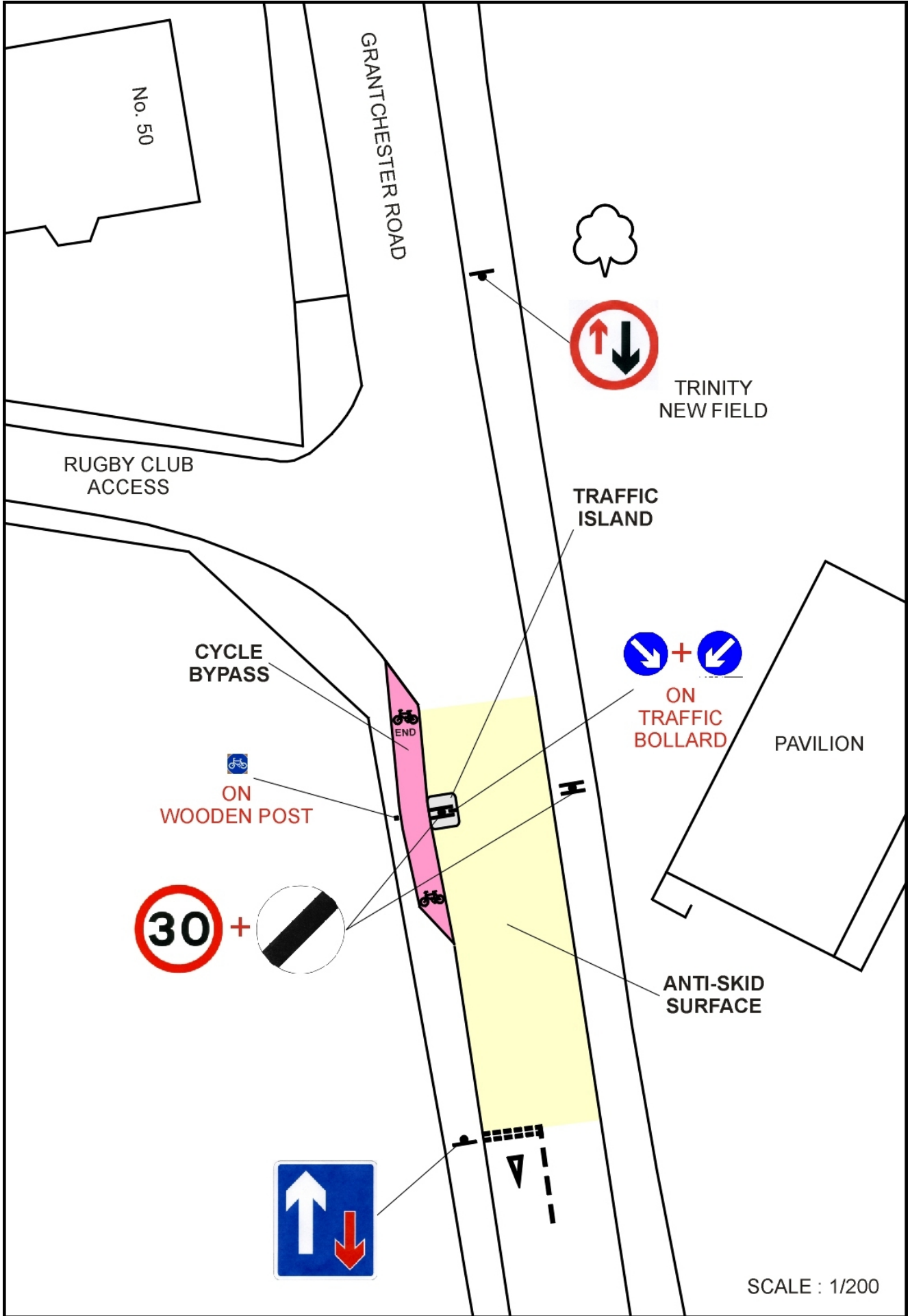

30 + [diagonal stripes]

SCALE : 1/200

## **APPENDIX B**

### **SUMMARY OF CONSULTATION RESPONSES**

Number of questionnaires distributed : 250 approx.

Number of questionnaires returned : 54

I believe that there are traffic related problems in Grantchester Road : 87%

I do not believe that there are traffic related problems in Grantchester Road : 12%

No opinion expressed regarding traffic related problems in Grantchester Road : 1%

The nature of traffic problems :-

Traffic speed : 65%

Parking - poor visibility for turning and crossing : 40%

Traffic volume : 17%

I support the proposal to introduce a 'gateway' feature as shown in the consultation leaflet : 71%

I oppose the proposal to introduce a 'gateway' feature as shown in the consultation leaflet : 17%

No opinion expressed regarding the proposal to introduce a 'gateway' feature as shown in the consultation leaflet : 12%

Suggest the introduction of parking restrictions between the 'gateway' and Barton Road: 21%

Suggest the introduction of speed humps between the 'gateway' and Barton Road : 13%

No other suggestions were made in 10% or more of responses.

Suggestions made in one or more responses were :-

A 40 mph speed limit between Grantchester and Newnham

A 30 mph speed limit between Grantchester and Newnham

A 20 mph speed limit in Grantchester Road

Speed limit markings on the road surface

A pedestrian crossing in Grantchester Road

A second traffic island to form a chicane

A speed camera

Automatic flashing 30 mph signs

The traffic island could be made more attractive

'Children crossing' signs

Move the Barton Road pedestrian crossing to the other side of the Grantchester Road junction

Rebuild the Selwyn Road traffic island to make it more attractive